

Coal Mines in Illinois
Florence Quadrangle

Scott & Pike Counties, Illinois

Colchester Coal

This map accompanies the Coal Mines Directory for the Florence Quadrangle. Consult the directory for a complete explanation of the information shown on this map.

Mining Method

- Room & Pillar (RP)
- Room & Pillar Basic (RPB)
- Modified Room & Pillar (MRP)
- Room & Pillar Panel (RPP)
- Blind Room & Pillar (BRP)
- Checkerboard Room & Pillar (CRP)
- High Extraction Retreat (HER)
- Longwall (LW)
- Underground, Method Unknown
- Strip Mine
- Auger Mine
- General Area of Mining

Other Areas Depicted

- Non-Coal Mines

Source of Mine Outline

- Final Mine Map
- Not Final Mine Map
- Undated Mine Map
- Incomplete Mine Map
- Secondary Source Map

Tipple, Shaft, Slope, Drift Locations

- Strip Mine Tipple - Active
- Strip Mine Tipple - Abandoned
- Mine Shaft - Active
- Mine Shaft - Abandoned
- Mine Slope - Active
- Mine Slope - Abandoned
- Mine Drift - Active
- Mine Drift - Abandoned
- Air Shaft
- Uncertain Location
- Uncertain Type of Opening

Other Points Depicted

- Non-Coal Mines

Location

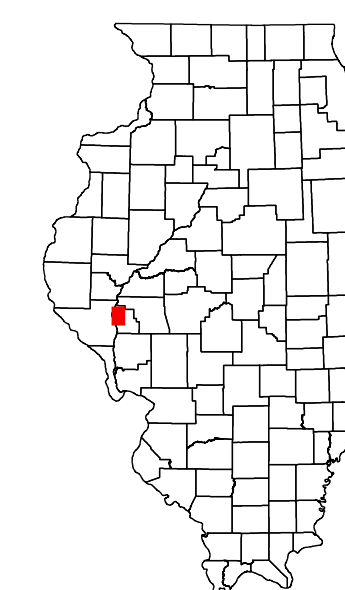
Mine Annotation
(space permitting)

Company
Mine Name
ISGS Index No., Years of Operation

Disclaimer

Please check the Coal Section at the Illinois State Geological Survey's web site at <https://www.isgs.illinois.edu> for the most up-to-date version of these products.

Note that each quadrangle scale mined-out area map requires the use of the associated text directory for full explanation of map features and mine attributes. Also note that some quadrangles have multiple seams of mining and therefore more than one map may be available for a particular quadrangle. Please take care to check for multiple maps, as extensive mining may exist in the other seams.

The maps and digital files used for these studies were compiled from data obtained from a variety of public and private sources and have varying degrees of completeness and accuracy. This compilation map presents reasonable interpretation of the geology of the area and is based on available data. Locations of some mine features may be offset by 500 feet or more due to errors in the original source maps, the compilation process, digitizing, or a combination of these factors. These data are not intended for use in site-specific screening or decision-making. Use of these documents does not eliminate the need for detailed studies to fully understand the geology of a specific site. The Illinois State Geological Survey, Prairie Research Institute, or the University of Illinois make no guarantee, expressed or implied, regarding the correctness of the interpretations presented in this data set and accept no liability for the consequences of decisions made by others on the basis of the information presented here.

These maps were designed for use at 1:24,000. Enlarging the map may reduce accuracy, as the original scale of the source maps used to compile the outlines shown varies from 1:400 to 1:150,000, and some mine locations are known only from text descriptions. See the accompanying mine directory for the original scale of the source map used for a specific mine to check accuracy of a given portion of the map. Areas with no mines shown may still be undermined; see the unlocated mines list at the back of each mine directory.

The image of the U.S.G.S. topographic base map was projected from the original UTM to Lambert Conformal Conic.

ILLINOIS
Illinois State Geological Survey
PRAIRIE RESEARCH INSTITUTE

Prairie Research Institute
Illinois State Geological Survey
615 E. Peabody Dr.
Champaign, IL 61820

Mine Outlines Compiled by
C. Chenoweth

June 2017

Produced by the United States Geological Survey

North American Datum of 1983 (NAD83)
World Geodetic System of 1984 (WGS84). Projection and
1 000-meter grid/Universal Transverse Mercator, Zone 15S
This map is not a legal document. Boundaries may be
generalized for this map scale. Private lands within government
reservations may not be shown. Obtain permission before
entering private lands.

Images:.....NAP, July 2019 - July 2019
Roads:.....U.S. Census Bureau, 2017
Names:.....U.S. Census Bureau, 2017
Hydrography:.....National Hydrography Dataset, 2007 - 2016
Contours:.....National Elevation Dataset, 2017
Boundaries:.....Multiple sources; see metadata file 2018, 2019
Public Land Survey System:.....BLM, 2020
Wetlands:.....FWS National Wetlands Inventory Not Available

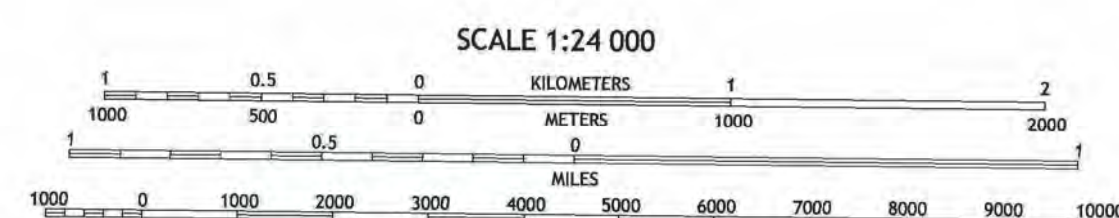
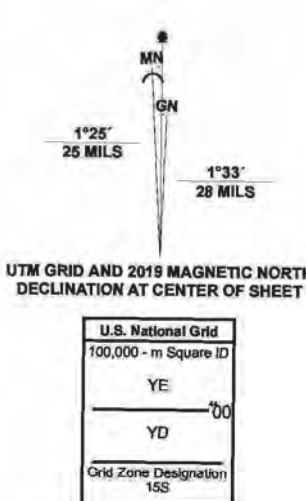

CONTOUR INTERVAL 10 FEET
NORTH AMERICAN DATUM OF 1983
This map was produced to conform with the
National Geospatial Program US Topo Product Standard.



1	2	3	1 Perry East
4	5	6	2 Mercedola
7	8	9	3 Chagrin
10	11	12	4 Grapenville
13	14	15	5 Winchester
16	17	18	6 Milton
19	20	21	7 Bedford
22	23	24	8 Aley

FLORENCE, IL
2021

DIRECTORY OF COAL MINES IN ILLINOIS

7.5-MINUTE QUADRANGLE SERIES

FLORENCE QUADRANGLE

SCOTT & PIKE COUNTIES

C. Chenoweth



2017

Prairie Research Institute
Mark Ryan, Executive Director
ILLINOIS STATE GEOLOGICAL SURVEY
Richard C. Berg, Director

Natural Resources Building
615 East Peabody Drive
Champaign, Illinois 61820



This material is based upon work supported by the Illinois Department of Transportation. Any opinions, findings, and conclusions or recommendations expressed in this publication are those of the authors and do not necessarily reflect the views of the Illinois Department of Transportation.

Cover photo Track-mounted duckbill loading machine at a Peabody Coal Company mine, ca. 1915.

DISCLAIMER: The accuracy and completeness of mine maps and directories vary with the availability of reliable information. Maps and other information used to compile this mine map and directory were obtained from a variety of sources and the accuracy of some of the original information cannot be verified. Consequently, the Illinois State Geological Survey (ISGS) cannot guarantee the mine maps are free of errors and disclaims any responsibility for damages that may result from actions or decisions based on them.

The ISGS updates the maps and directories periodically, and welcomes any new information or corrections. Please contact the Coal Section of the ISGS at the address shown on the title page of this directory.

© 2017 The Board of Trustees of the University of Illinois. All rights reserved.
For permission information, contact the Illinois State Geological Survey.

CONTENTS

INTRODUCTION	1
MINING IN THE FLORENCE QUADRANGLE	1
PART I EXPLANATION OF MAP AND MINE SUMMARY SHEET	2
INTERPRETING THE MAP	2
Mine Type and Mining Method	2
Source Maps	3
Points and Labels	3
INTERPRETING A MINE SUMMARY SHEET	6
REFERENCES	8
PART II DIRECTORY OF MINES IN THE FLORENCE QUADRANGLE	9
MINE SUMMARY SHEETS	9
Mine Index 316	
William Kund, Kund Mine	9
Mine Index 2815	
Louisa Jones, Jones Mine	10
Mine Index 3447	
Ed Rauff, Peak's Mine	11
Mine Index 6725	
Charles Taylor, Taylor Mine	12
OTHER MINES SHOWN IN THE FLORENCE QUADRANGLE	13
Mine Index 7748	13
Mine Index 7749	13
Mine Index 7750	13
Mine Index 7751	13
Mine Index 7754	13
Mine Index 7755	13
Mine Index 7756	13
MINES WHOSE LOCATIONS ARE NOT KNOWN, FLORENCE QUADRANGLE	13
INDEX OF MINES IN THE FLORENCE QUADRANGLE	15

INTRODUCTION

Coal has been mined in 76 counties of Illinois. More than 7,400 coal mines have operated since commercial mining began in Illinois about 1810; fewer than 30 are currently active. To detail the extent and location of coal mining in Illinois, the Illinois State Geological Survey (ISGS) has compiled maps and directories of known coal mines. The ISGS offers maps at a scale of 1:100,000 and accompanying directories for each county in which coal mining is known to have occurred. Maps at a scale of 1:24,000 and accompanying directories, such as this, are available for selected quadrangles. Contact the ISGS for a list of these quadrangles.

These larger scale maps show the approximate positions of mines in relation to surface features such as roads and water bodies, and indicate the mining method used and the accuracy of the mine boundaries. The maps are useful for locating mine boundaries relative to specific properties and for assessing the potential for subsidence in an area. Mine boundaries compiled from final mine surveys are generally shown within 200 feet of their true position. As a result of poor cartographic quality and inaccuracies in the original mine surveys, boundaries of some older mines may be mislocated on the map by 500 feet or more. Original mine maps should be consulted in situations that require precise delineation of mine boundaries or internal workings of mined areas.

This directory serves as a key to the accompanying mine map and provides basic information on the coal mines in the quadrangle. The directory is composed of two parts. Part I explains the symbols and patterns used on the accompanying map and the summary data presented for each mine. Part II numerically lists the mines in the quadrangle and summarizes the geology and production history of each mine. Total production for the mine, not the portion in the quadrangle, is given.

MINING IN THE FLORENCE QUADRANGLE

The Colchester Coal was mined in the Florence Quadrangle, and the coal was generally about 2.5 feet thick. Most of the mines were close to the surface and accessed through drifts, slopes, or shallow shafts. Where the coal was deeper, such as in plains areas between streams, the required depth of the shaft made the coal uneconomical to mine. The mines were small and produced coal for the local market. Most of the mining ended in 1928 with the closing of the Taylor Mine (mine index 6725), with the possible exception of a couple of unlocated mines near Exeter (generally east of the Florence Quadrangle) that operated in the 1930s.

PART I EXPLANATION OF MAP AND MINE SUMMARY SHEET

INTERPRETING THE MAP

The map accompanying this directory shows the location of coal mines known to be present in the quadrangle. The map, corresponding to a U.S. Geological Survey (USGS) 7.5-minute quadrangle, covers an area bounded by lines of latitude and longitude 7.5-minutes apart. In Illinois, a quadrangle is approximately 6.5 miles east to west and 8.5 miles north to south, an area of about 56 square miles. The USGS generally offers one map of mines per quadrangle. In some areas where extensive mining occurred in two or more overlapping seams, separate maps are compiled for mines in each seam to maintain readability of the map.

Mine Type and Mining Method

The mine type is indicated on the map by pattern color: green represents surface mines; red and yellow represent underground mines. The red patterns are used for areas of underground mining that are documented by a primary or secondary source map. A yellow pattern is used for cases where no map of the mine workings is available, but a general area of mining can be inferred from property maps or production figures. The patterns indicate the main mining methods used in underground mines. The methods are (1) room and pillar and (2) high extraction. The method used gives some indication of the amount and pattern of coal extraction within each mined area, and has some influence on the timing and type of subsidence that can occur over a mine.

The following discussion and illustrations of mining methods are based on Guither et al. (1984).

In room-and-pillar mines, coal is removed from haulage-ways (entries) and selected areas called rooms. Pillars of unmined coal are left between the rooms to support the roof. Depending on the size of rooms and pillars, the amount of coal removed from the production areas will range from 40% to 70%.

Room and Pillar - mining is divided into six categories:

- room-and-pillar basic (RPB, fig. 1A), an early method that did not follow a preset mining plan and therefore resulted in very irregular designs;
- modified room and pillar (MRP, fig. 1B);
- room-and-pillar panel (RPP, fig. 1C);
- blind room and pillar (BRP, fig. 1D);
- checkerboard room and pillar (CRP, fig. 1E);
- room and pillar (RP), a classification used when the specific type of room-and-pillar mining is unknown.

Blind and checkerboard are the most common types of room-and-pillar mining used in Illinois today. The knowledge of room-and-pillar mining methods gives a trained engineer information on the nature of subsidence that may occur. A more extensive discussion of subsidence can be found in Bauer et al. (1993).

High-extraction These mining methods are subdivided into high-extraction retreat (HER, Fig 1F) and longwall (LW, Fig 1G, 1H). In these methods, much of the coal is removed within well defined areas of the mine. Subsidence of the surface above these areas occurs within weeks. Once the subsidence activity ceases, the potential for further movement over these areas is low; however, subsidence may continue for several years after mining.

High-extraction retreat mining is a form of room-and-pillar mining that extracts most of the coal. Rooms and pillars are developed in the panels, and the pillars are then systematically removed (fig. 1F).

In early (pre-1960) longwall mines, mining advanced in multiple directions from a central shaft (fig. 1G). Large pillars of coal were left around the shaft, but all coal was removed beyond these pillars. Miners placed rock and wooden props and cribs in the mined-out areas to support the mine roof. The overlying rock gradually settled onto these supports, thus producing subsidence at the surface. In post-1959 longwall mines, room-and-pillar methods have been used to develop the main entries of the mine and panel areas. Modern longwall methods extract 100 percent of the coal in the panel areas (fig. 1H).

Source Maps

Mine outlines depicted on the map are, whenever possible, based on maps made from original mine surveys. The process of compiling and digitizing the quadrangle map may produce errors of less than 200 feet in the location of mine boundaries. Larger errors of 500 feet or more are possible for mines that have incomplete or inaccurate source maps.

Because of the extreme complexity of some mine maps, detailed features of mined areas have been omitted. The digitized mine boundary includes the exterior boundary of all rooms or entries that were at least 80 feet wide or protruded 500 feet from the main mining area. Unmined areas between mines are shown if they are at least 80 feet wide; unmined blocks of coal within mines are shown if they are at least 400 feet on each side. Original source maps should be consulted when precise information on mine boundaries or interior features is needed.

The mine summary sheet lists the source maps used to determine each mine outline. The completeness of map sources is indicated on the map by a line symbol at the mine boundary. Source maps are organized in five categories.

Final mine map The mine outline was digitized from an original map made from mine surveys conducted within a few months after production ceased. The date of the map and the last reported production are listed on the summary sheet.

Not a final map The mine is currently active or the mine outline was made from a map based on mine surveys conducted more than a few months before production ceased. This implies the actual mined-out area is probably larger than the outline on the map. The mine summary sheet indicated the dates of source maps and the last reported production, as well as the approximate tonnage mined between these two dates (if the mine is abandoned). The summary sheet also lists the approximate acreage mined since the date of the map and, in some cases, indicates the area where additional mining may have taken place. This latter information is determined by locating on the map the active faces relative to probable boundaries of the mine property.

Undated map The source map was undated, so it may or may not be based on a final mine survey. When sufficient data are available, the probable acreage of the mined area is estimated from reported production, average seam thickness and a recovery rate comparable to other mines in the area. This information is listed in the summary sheet for the mine.

Incomplete map The source map did not show the entire mine. The summary sheet indicates the missing part of the mine map and the acreage of the unmaped area, which is estimated from the amount of coal known to have been produced from the mine.

Secondary source map The original mine map was not found so the outline shown was determined from secondary sources (e.g., outlines from small-scale regional maps published in other reports). The summary sheet describes the secondary sources.

Points and Labels

The locations of all known mine openings (shafts, slopes, and drifts) and surface mine tipples are plotted on the map. Tipples are areas where coal was cleaned, stockpiled, and loaded for shipping.

Only openings or tipples are plotted for mines without source maps. If the precise locations of these features are unknown, a special symbol is used to indicate the approximate location of the mine.

Each mine on the map is labeled with the names of the mine and operating company, ISGS mine index number, and years of operation (if known) if space permits. A seam designation is given on maps where more than one seam was mined. For a mine that operated under more than one name, only the most recent name is generally given. When a mine changed names or ownership shortly before closing, an earlier name is listed. All company and mine names are listed on the mine summary sheet in the directory, under the production history segment.

Figure 1 Mining methods: (A) room-and-pillar basic (RPB), (B) modified room and pillar (MRP), (C) room-and-pillar panel (RPP), (D) blind room and pillar (BRP).

Figure 1 (*cont.*) Mining methods: (E) checkerboard room and pillar (CRP), (F) high extraction retreat (HER), (G) early (pre-1960) longwall, (H) post-1959 longwall

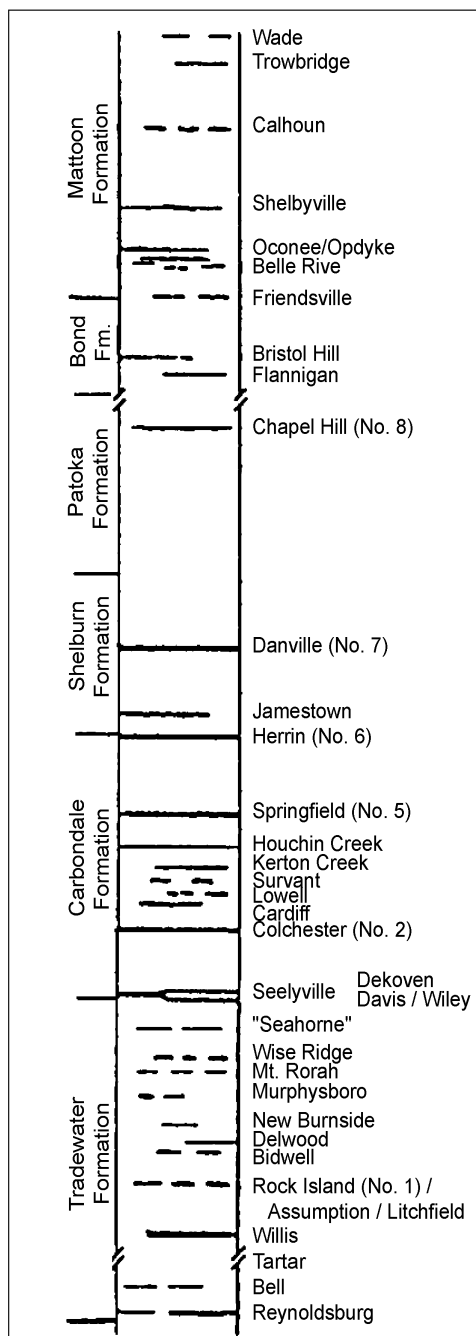

Figure 2 Generalized stratigraphic section, showing approximate vertical relations of coals in Illinois.

INTERPRETING A MINE SUMMARY SHEET

The mine summary sheet is arranged numerically by mine index number. Index numbers are shown on the map and in the mine listing. The mine summary sheet provides the following information (if available).

Company and mine name The last company or owner of the mine is used, unless no production was recorded for the last owner. In that case, the penultimate owner is listed. Mines often have no specific name; in these cases, the company name is also used as the mine name.

Type *Underground* denotes a subsurface mine in which the coal was reached through a shaft, slope, or a drift entry. *Surface* denotes a surface, open pit or strip mine.

Total mined-out acreage shown The total acreage of the mined area mapped, including any acreage mined on adjacent quadrangles, is calculated from the digitized outline of the mine. The acreage of large barrier pillars depicted on the map is excluded from the mined-out acreage. Small pillars not digitized are included in the acreage calculation. If the mine outline is not based on a final mine map, the acreage is followed by an estimate of additional acres that may have been mined. The estimate is determined from reported mine production, approximate thickness of the coal, and recovery rates calculated from nearby mines that used similar mining methods.

SHAFT, SLOPE, DRIFT OR TIPPLE LOCATIONS

Shaft, slope, drift, or tippie locations Locations of all known former entry points to underground mines or the location of coal cleaning, tippie, and shipping equipment used by the mine's facility are listed. The location is described in terms of county, township and range (Twp-Rge), section, and location within the section by quarters. NE SW NW, for instance, would describe the location in the northeast quarter of the southwest quarter of the northwest quarter. Approximate footage from the section lines (FEL = from east line, FNL = from north line, for example) is given when that information is known; this indicates a surveyed location and is not derived from maps. Entry points are also plotted on the map and coded for the type of entry or tippie. A mine opening may have had many purposes during the life of the mine. Old hoist shafts are often later used for air and escape shafts; this information is included in the directory when known. The tippie for underground mines was generally located near the main shaft or slope. At surface mines, coal was sometimes hauled to a central tippie several miles from the mine pit.

GEOLOGY

Seam(s) mined The name of the coal seam(s) mined is listed, if known. If multiple seams were mined, they are all listed, although the mined-out area for each seam may be shown on separate maps. Figure 2 shows the stratigraphic section of the coal-bearing interval in Illinois, and the vertical relations among the coals.

Depth The depth to the top of the seam in the vicinity of the shaft is listed, if known. The depth is determined from notes made by geologists who visited the mine during its operation or from drill hole data in ISGS files. Depth generally varies little over the extent of a mine; however, reported depths for an individual mine may vary. Depth for surface-mined coals varies, and is usually represented as a range.

Thickness The approximate thickness of the mined seam is shown, if known. Thickness also comes from notes of geologists who visited the mine during its operation or from borehole data in ISGS files. Minimum, maximum, and average thicknesses are given when this information is available.

Mining method The principal mining method used at the mine (figs. 1A-H) is listed. See the mining methods section at the beginning of this directory for a discussion of this parameter.

Geologic problems reported Any known geologic problems, such as faults, water seepage, floor heaving, and unstable roof, encountered in the mine are reported. This information is from notes made by ISGS geologists who visited the mine, or from reports by mine inspectors published by the Illinois Department of Mines and Minerals, or from the source map(s). Geologic problems are not reported for active mines.

PRODUCTION HISTORY

Production history Tons of coal produced from the mine by each mine owner are totaled. When the source map used for the mine outline is not a final mine map, the tonnage produced since the date of the map is identified. For mines that extend into adjacent quadrangles, the tonnage reported includes areas mined in adjacent quadrangles.

SOURCE OF DATA

Source map This section lists information about the map(s) used to compile the mine outline and the locations of tipples and mine openings. In some cases more than one source map was used. For example, a map drawn before the mine closed may provide better information on original areas of the mine than a later map. When more than one map was used, the bibliography section explains what information was taken from each source.

Date The date of the most recent mine survey listed on the source map is reported.

Original scale The original scale of the source map is listed. Many maps are photo-reductions and are no longer at their original scale. The original scale gives some indication of the level of detail of the mine outline and the accuracy of the mine boundary relative to surface features. Generally, the larger the scale, the greater the accuracy and detail of the mine map. Mine outlines taken from source maps at scales smaller than 1:24,000 may be highly generalized and may well be inaccurately located with respect to surface features.

Digitized scale The scale of the digitized map is reported. The scale may be different from that of the original source map. In many cases the digitized map was made from a photo-reduction of the original source map, or the source map was not in a condition suitable for digitizing, and the mine boundaries were transferred to another base map.

Map type Source maps are classified into five categories to indicate the probable completeness of the map. See discussion of source maps in the previous section.

Annotated bibliography Sources that provide information about the mine are listed, with the data taken from each source. Some commonly used sources are described below. Full bibliographic references are given for all other sources. Unless otherwise noted, all sources are available for public inspection at the ISGS.

Coal Reports Published since 1881, these reports contain tabular data on mine ownership, production, employment, and accidents. Some volumes include short descriptions made by mine inspectors of physical features and conditions in selected mines.

Directory of Illinois Coal Mines This source is a compilation of basic data about Illinois coal mines, originally gathered by ISGS staff in the early 1950s. Sources used for this directory are undocumented, but they are primarily Illinois Department of Mines and Minerals annual reports, ISGS mine notes, and coal company officials.

ENR Document 85/01, Guither, H. D., J. K. Hines, and R. A. Bauer, 1985 The Economic Effect of Underground Mining Upon Land Used for Illinois Agriculture: Illinois Department of Energy and Natural Resources Document 85/01, 185 p.

Microfilm map The U.S. Bureau of Mines maintains a microfilm archive of mine maps. A microfilm file for Illinois is available for public viewing at the ISGS.

Mine notes ISGS geologists have visited mines or contacted mine officials throughout the state since the early 1900s. Notes made during these visits range from brief descriptions of the mine location to long narratives (including sketches) of mining conditions and geology.

Federal Land Bank of St. Louis, Preliminary Reports on Subsidence Investigations Mining engineers working for the Federal Land Bank of St. Louis mapped areas of subsidence due to coal mining in the early 1930s. These reports often include county maps of mine properties with mined-out areas including shaft locations, as well as subsidence areas.

REFERENCES

Bauer, R. A., B. A. Trent, and P. B. Dumontelle, 1993, Mine Subsidence in Illinois: Facts for the Homeowner Considering Insurance, Illinois State Geological Survey, Environmental Geology Note 144, 16p.

Guither, H. D., J. K. Hines, and R. A. Bauer, 1985, The Economic Effects of Underground Mining Upon Land Used for Illinois Agriculture, Illinois Department of Energy and Natural Resources Document 85/01, 185p.

Worthen, A. H., H. Engelmann, H. C. Freeman, and H. M. Bannister, 1868, Geology and Paleontology of Illinois, Volume III, State Journal Steam Press, Springfield, Illinois, 574p.

PART II DIRECTORY OF MINES IN THE FLORENCE QUADRANGLE

MINE SUMMARY SHEETS

A summary sheet on the geology and production history of each mine in the Florence Quadrangle is provided. These summary sheets are arranged numerically by mine index number. Consult Part I for a complete explanation of the data listed in the summary sheet.

Mine Index 316

William Kund, Kund Mine

Type: Underground Total mined-out acreage shown: None; production indicates approximately 4 acres were mined.

SHAFT, SLOPE, DRIFT or TIPPLE LOCATIONS

Type	County	Township-Range	Section	Quarters-Footage
Main drift	Scott	15N 13W	23	NE

GEOLOGY

Seam(s) Mined	Depth (ft)	Thickness (ft)			Mining Method
		Min	Max	Avg	
Colchester	75-80	1.5	2.67	2.33	RP

Geologic Problems Reported: The roof was 4 feet of black fissile shale. A small fault or horseback was noted with 4 inches of displacement. The floor was 30 inches of soft gray clay-rich shale.

PRODUCTION HISTORY

Company	Mine Name	Years	Production (tons)
William Kund	Kund	1901-1909	<u>7,638</u> 7,638

Last reported production: 1909

SOURCES OF DATA

Source Map	Date	Original Scale	Digitized Scale	Map Type
Mine notes (Jon A. Udden)	11-18-1909	1:62500	1:62500	Secondary source

Annotated Bibliography (data source, brief description of information)

Coal Reports - Production, ownership, years of operation, depth.

Directory of Illinois Coal Mines (Scott County) - Mine names, mine index, ownership, years of operation.

Mine notes (Scott County) - Mine type, drift location, seam, thickness, mining method, geologic problems.

Mine Index 2815
Louisa Jones, Jones Mine

Type: Underground Total mined-out acreage shown: None; production indicates less than 1 acre was mined.

SHAFT, SLOPE, DRIFT or TIPPLe LOCATIONS

Type	County	Township-Range	Section	Quarters-Footage
Main drift	Scott	15N 13W	23	

GEOLOGY

Seam(s) Mined	Depth (ft)	Thickness (ft)			Mining Method
		Min	Max	Avg	
Colchester	12-50			2.5	Underground

Geologic Problems Reported:

PRODUCTION HISTORY

Company	Mine Name	Years	Production (tons)
Robert C. Jones	Jones	pre1881-1882	150
Louisa Jones	Jones	1882-1883	<u>40</u> 190

Last reported production: 1883

SOURCES OF DATA

Source Map	Date	Original Scale	Digitized Scale	Map Type
Coal Report	1883	(text only)	1:24000 *	Secondary source

* The mine location was plotted on a 1:24000 USGS topographic map from the mine location description and digitized.

Annotated Bibliography (data source, brief description of information)

Coal Reports - Production, ownership, years of operation, mine type, location, seam, depth, thickness.
 Directory of Illinois Coal Mines (Scott County) - Mine names, mine index, ownership, years of operation.

Mine Index 3447
Ed Raft, Peak's Mine

Type: Underground Total mined-out acreage shown: None; production indicates approximately 2 acres were mined.

SHAFT, SLOPE, DRIFT or TIPPLE LOCATIONS

Type	County	Township-Range	Section	Quarters-Footage
Main drift	Scott	15N 13W	25	SW NW NW

GEOLOGY

Seam(s) Mined	Depth (ft)	Thickness (ft)			Mining Method
		Min	Max	Avg	
Colchester	28-55	2.2	2.8	2.33-2.5	RP

Geologic Problems Reported: The immediate roof was 16 inches of soapstone. Pyrite was present as lenses and fracture facings.

PRODUCTION HISTORY

Company	Mine Name	Years	Production (tons)
Ed Raft *	Peak	1899-1911 **	4,145 4,145

* A mine was shown in the mine notes at this location, but named Peak's Mine. As the location encompasses 10 acres, it is possible, even likely, that two different mines worked the same location. However, the mine notes are not dated, and no operator named Peak was listed in the Coal Reports, so the data from both operators are concatenated here.

** Idle 1902

Last reported production: 1911

SOURCES OF DATA

Source Map	Date	Original Scale	Digitized Scale	Map Type
Mine notes (John S. Ivy)	5-15-1922	1:62500	1:62500	Secondary source

Annotated Bibliography (data source, brief description of information)

Coal Reports - Production, ownership, years of operation, mine type, depth, thickness, mining method.
 Directory of Illinois Coal Mines (Scott County) - Mine names, mine index, ownership, years of operation.
 Mine notes (Scott County) - Mine type, drift location, thickness, geologic problems.

Mine Index 6725
Charles Taylor, Taylor Mine

Type: Underground Total mined-out acreage shown: None; production indicates approximately 2 acres were mined.

SHAFT, SLOPE, DRIFT or TIPPLe LOCATIONS

Type	County	Township-Range	Section	Quarters-Footage
Drift	Scott	15N 12W	26	NE SE NE

GEOLOGY

Seam(s) Mined	Depth (ft)	Thickness (ft)			Mining Method
		Min	Max	Avg	
Colchester	40-90			2.5	RP

Geologic Problems Reported:

PRODUCTION HISTORY

Company	Mine Name	Years	Production (tons)
Charles Taylor	Taylor	1914-1928	<u>4,930</u> 4,930

Last reported production: 1928

SOURCES OF DATA

Source Map	Date	Original Scale	Digitized Scale	Map Type
ISGS field notes (A. H. Bell)	9-13-1927	1:62500	1:62500	Secondary source

Annotated Bibliography (data source, brief description of information)

Coal Reports - Production, ownership, years of operation, mine type, seam, depth, thickness, mining method.
 Directory of Illinois Coal Mines (Scott County) - Mine names, mine index, ownership, years of operation, seam.
 ISGS field notes (Scott County) - Drift location.

OTHER MINES SHOWN IN THE FLORENCE QUADRANGLE

Mine Index 7748 NE NE NW 26-T15N-R13W, surface, very shaley and dirty, 1.0-1.5 feet thick
source: ISGS field notes (E. T. Benson, circa 1935)

Mine Index 7749 SE SE SW 26-T15N-R13W, drift source: ISGS field notes (John Svatik, 7-13-1929)

Mine Index 7750 W ½ W ½ SE 26-T15N-R13W, mine source: ISGS field notes (K. W. Stott, 9-13-1927)

Mine Index 7751 S ½ S ½ SE 23-T15N-R13W, drifts along bluff source: ISGS field notes (John S. Ivy, 10-9-1922)

Mine Index 7754 SW SE SW 23-T15N-R13W, surface, 1.5-4.0 feet thick source: ISGS field notes (A. H. Bell, 10-28-1927 & E. T. Benson, circa 1935)

Mine Index 7755 SW NE SW 23-T15N-R13W, shaft, 30 feet deep source: ISGS field notes (A. H. Bell, 10-28-1927)

Mine Index 7756 NW SE SW 14-T15N-R13W, surface, 2.5 feet thick source: ISGS field notes (A. H. Bell, 10-25-1927)

MINES WHOSE LOCATIONS ARE NOT KNOWN, FLORENCE QUADRANGLE

The locations of the following mines are unknown, but the production tonnage, operating names, and nearest town were reported in the Annual Coal Reports. The operators listed below mined in the Florence Quadrangle. The information shown is similar to that presented on the summary sheets in the previous pages of this directory. The first item is the name the mine operated under as listed in the Coal Report, then the years the mine reported. If no physical data are available, the next item listed is the total tons produced by the mine. If physical data are available, the order of presentation is as follows: type of opening for the mine (drift, slope or shaft), depth of coal in feet, and thickness of coal in feet.

The total tons mined by these unlocated mines is 19,757 (16,197 underground and 3,560 mined by uncertain method), which would represent approximately 7 to 12 acres, depending on the recovery factor, mining method, and numerous other factors. (Note: 1 square mile = 640 acres)

BLUFFS

Meyer (H. H.), 1893-1895, drift, Colchester, —, 2.5, RP	400 tons	index 91716707a
Meier (H. H.), 1900-1901, drift, —, —, 2.5, RP	28 tons	index 91716707b
Myers (William), 1917-1921, Colchester	445 tons	index 91716708
Priest (Charles), 1902-1903, drift, Colchester, —, 2.5, RP	245 tons	index 91716714
Middendorg (William), 1924-1925, Colchester	56 tons	index 91716719
Brown Mine, 1926-1926	<u>50 tons</u> 106 tons	

EXETER

Funk (Clark), 1881-1882, drift, Colchester, 75, 2.5	50 tons	index 91712860
Sutcliffe (Elihu), 1881-1882, drift, Colchester, 20, 2.5	50 tons	index 91713741
Stewart (J. H.), 1889-1890	35 tons	index 91715187a
Arnold (Lafayette), 1881-1882, drift, Colchester, 75, 2.5	10 tons	index 91715950
Ratigan (D.), 1914-1918, drift, Colchester, 40, 2.5, RP	980 tons	index 91716152
Ratigan & Buchanan, 1896-1897, drift, —, —, 2.33, RP	720 tons	index 91716152a

Dunn (Clyde), 1910-1911, drift, Colchester, 60, 2.5, RP	900 tons	index 91716676
Moore (Isaac), 1915-1916, drift, Colchester, 60, 2.5, RP	275 tons	index 91716680
Berry (Pat), 1899-1901, drift, Colchester, 30, 2.5, RP	330 tons	index 91716683
Brown (Robert L.), 1916-1919, slope, Colchester, 50, 2.5, RP	1,240 tons	index 91716685
Brown (T. W.), 1917-1919, Colchester	1,000 tons	index 91716686
Six (Manuel), 1899-1902, drift, Colchester, 25-32, 2.5, RP	400 tons	index 91716688
Six & Peake, 1902-1903	560 tons	
Six (M.), 1903-1904	<u>210 tons</u>	
	1,170 tons	
Chance (John), 1917-1918, Colchester	549 tons	index 91716689
Morris (James F.), 1889-1895, drift, —, 20, 2.5-2.67, RP	999 tons	index 91716694a
Morris (James T.), 1910-1911, drift, —, 60, 2.5, RP	750 tons	index 91716694b
Morris (James J.), 1914-1917, drift, Colchester, 30-45, 2.5, RP	3,610 tons	index 91716694c
Armitage (Elihu), 1889-1892, drift, —, 16, 2.5, RP	138 tons	index 91716695a
Armitage (W.), 1896-1898, drift, —, 30-45, 2.33-2.5, RP	840 tons	index 91716695b
Brown (James M.), 1899-1900	160 tons	
Brown (B.), 1902-1903	120 tons	
Armitage & Brown, 1903-1904	310 tons	
Armitage (Walter), 1904-1905	<u>320 tons</u>	
	1,750 tons	
Armitage (Walter), 1909-1911, drift, —, 60, 2.5, RP	880 tons	index 91716695c
Ruh (Charles), 1895-1897, shaft, Colchester, 18, 2.3, RP	760 tons	index 91716706
Yarding (E.), 1902-1904, drift, Colchester, —, 2.5, RP	310 tons	index 91716715
Clark (W. O.), 1918-1921, Colchester	438 tons	index 91716727a
Clark (William O.), 1926-1926	85 tons	index 91716727b
Clark (W. O.), 1927-1929	<u>350 tons</u>	
	435 tons	
Clark (Farrel), 1934-1935, underground	515 tons	index 91716727c
Hickok (Claude), 1919-1921, Colchester	112 tons	index 91716728
Haskins (D. S.), 1922-1923, Colchester	240 tons	index 91716729
Korty (John), 1922-1923	200 tons	index 91716730a
Korty (John G.), 1934-1934, Colchester, underground	150 tons	index 91716730b
Korty & Collison, 1935-1935	<u>142 tons</u>	
	292 tons	
Neat (C. L.), 1934-1934, Colchester, underground	250 tons	index 91716735
Beckman (J. E.), 1934-1935, Colchester, underground	260 tons	index 91716737
Morris (J. I. "Ike"), 1935-1936, Colchester, underground	418 tons	index 91716738

INDEX OF MINES IN THE FLORENCE QUADRANGLE

Peake (Six & Peake)	14
Armitage (Elihu)	14
Armitage (W.)	14
Armitage (Walter)	14
Armitage & Brown	14
Arnold (Lafayette)	13
Beckman (J. E.)	14
Berry (Pat)	14
Brown (Armitage & Brown)	14
Brown (B.)	14
Brown (James M.)	14
Brown (Robert L.)	14
Brown (T. W.)	14
Brown Mine	13
Buchanan (Ratigan & Buchanan)	13
Chance (John)	14
Clark (Farrel)	14
Clark (W. O.)	14
Clark (William O.)	14
Collison (Korty & Collison)	14
Dunn (Clyde)	14
Funk (Clark)	13
Haskins (D. S.)	14
Hickok (Claude)	14
Jones (Louisa)	10
Jones (Robert C.)	10
Korty (John G.)	14
Korty (John)	14
Korty & Collison	14
Kund (William)	9
Meier (H. H.)	13
Meyer (H. H.)	13
Middendorg (William)	13
Moore (Isaac)	14
Morris (J. I. "Ike")	14
Morris (James F.)	14
Morris (James J.)	14
Morris (James T.)	14
Myers (William)	13
Neat (C. L.)	14
Peak's Mine	11
Priest (Charles)	13
Ratigan (D.)	13
Ratigan & Buchanan	13
Rauft (Ed)	11
Ruh (Charles)	14
Six (M.)	14
Six (Manuel)	14
Six & Peake	14
Stewart (J. H.)	13
Sutcliffe (Elihu)	13
Taylor (Charles)	12
Yarding (E.)	14

