

Coal Mines in Illinois Greenfield Quadrangle Greene, Macoupin & Jersey Counties, Illinois

This map accompanies the Coal Mines Directory for the Greenfield Quadrangle. Consult the directory for a complete explanation of the information shown on this map.

Mining Method

- Room & Pillar (RP)
- Room & Pillar Basic (RPB)
- Modified Room & Pillar (MRP)
- Room & Pillar Panel (RPP)
- Blind Room & Pillar (BRP)
- Checkerboard Room & Pillar (CRP)
- High Extraction Retreat (HER)
- Longwall (LW)
- Underground, Method Unknown
- Strip Mine
- Auger Mine
- General Area of Mining

Other Areas Depicted

- Non-Coal Mines

Source of Mine Outline

- Final Mine Map
- Not Final Mine Map
- Undated Mine Map
- Incomplete Mine Map
- Secondary Source Map

Tipple, Shaft, Slope, Drift Locations

- Strip Mine Tipple - Active
- Strip Mine Tipple - Abandoned
- Mine Shaft - Active
- Mine Shaft - Abandoned
- Mine Slope - Active
- Mine Slope - Abandoned
- Mine Drift - Active
- Mine Drift - Abandoned
- Air Shaft
- Uncertain Location
- Uncertain Type of Opening

Other Points Depicted

- Non-Coal Mines

Location



Mine Annotation (space permitting)

Company
Mine Name
ISGS Index No., Years of Operation

Disclaimer

Please check the Coal Section at the Illinois State Geological Survey's web site at <https://www.isgs.illinois.edu> for the most up-to-date version of these products.

Note that each quadrangle scale mined-out area map requires the use of the associated text directory for full explanation of map features and mine attributes. Also note that some quadrangles have multiple seams of mining and therefore more than one map may be available for a particular quadrangle. Please take care to check for multiple maps, as extensive mining may exist in the other seams.

The maps and digital files used for these studies were compiled from data obtained from a variety of public and private sources and have varying degrees of completeness and accuracy. This compilation map presents reasonable interpretation of the geology of the area and is based on available data. Locations of some mine features may be off by 500 feet or more due to errors in the original source maps, the compilation process, digitizing, or a combination of these factors. These data are not intended for use in site-specific screening or decision-making. Use of these documents does not eliminate the need for detailed studies to fully understand the geology of a specific site. The Illinois State Geological Survey, Prairie Research Institute, or the University of Illinois make no guarantee, expressed or implied, regarding the correctness of the interpretations presented in this data set and accept no liability for the consequences of decisions made by others on the basis of the information presented here.

These maps were designed for use at 1:24,000. Enlarging the map may reduce accuracy, as the original scale of the source maps used to compile the outlines shown varies from 1:400 to 1:150,000, and some mine locations are known only from text descriptions. See the accompanying mine directory for the original scale of the source map used for a specific mine to check accuracy of a given portion of the map. Areas with no mines shown may still be undermined; see the unlocated mines list at the back of each mine directory.

The image of the U.S.G.S. topographic base map was projected from the original UTM to Lambert Conformal Conic.

ILLINOIS
Illinois State Geological Survey
PRAIRIE RESEARCH INSTITUTE

Prairie Research Institute
Illinois State Geological Survey
615 E. Peabody Dr.
Champaign, IL 61820

Mine Outlines Compiled by
C. Chenoweth & Alan R. Myers

December 11, 2023

Produced by the United States Geological Survey
North American Datum of 1983 (NAD83)
World Geodetic System of 1984 (WGS84), Projection and
1:250,000-meter grid/Universal Transverse Mercator, Zone 18S
This map is not a legal document. Boundaries may be
generalized for this map scale. Private lands within government
reservations may not be shown. Obtain permission before
entering private lands.

Imagery.....NAIP, August 2013, October 2015
Roads.....U.S. Census Bureau, 2017
Names.....U.S. Census Bureau, 1980 - 2017
Hydrography.....National Hydrography Dataset, 2004 - 2017
Contours.....National Elevation Dataset, 2008 - 2012
Boundaries.....Multiple sources; see metadata file 2014 - 2016
Public Land Survey System.....BLM, 2017
Wetlands.....FWS National Wetlands Inventory 1983

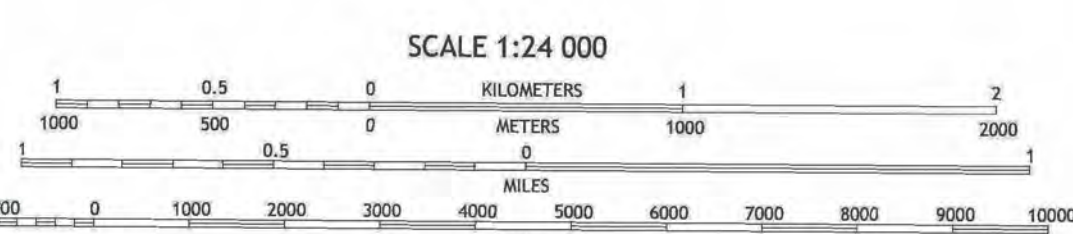
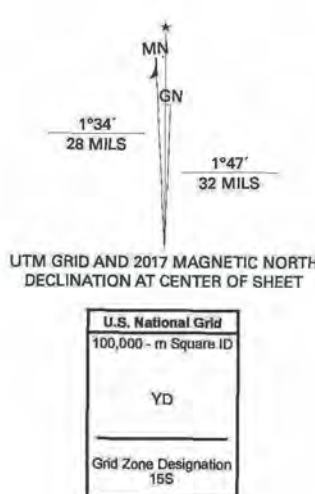

CONTOUR INTERVAL 10 FEET
NORTH AMERICAN DATUM OF 1983
This map was produced to conform with the
National Geospatial Program US Topo Product Standard, 2015.
A metadata file associated with this product is draft version 0.6.18

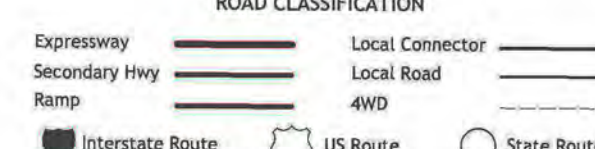
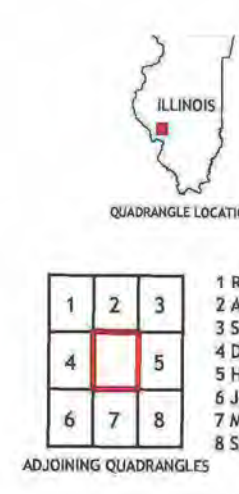

GREENFIELD, IL
2018

DIRECTORY OF COAL MINES IN ILLINOIS 7.5-MINUTE QUADRANGLE SERIES GREENFIELD QUADRANGLE GREENE, MACOUPIN & JERSEY COUNTIES

Jennifer M. Obrad & Alan R. Myers



2023

Prairie Research Institute
Praveen Kumar, Executive Director
ILLINOIS STATE GEOLOGICAL SURVEY
Richard C. Berg, Director

Natural Resources Building
615 East Peabody Drive
Champaign, Illinois 61820

Phone (217) 333-4747



This material is based upon work supported by the Illinois Mine Subsidence Insurance Fund. Any opinions, findings, and conclusions or recommendations expressed in this publication are those of the authors and do not necessarily reflect the views of the Illinois Mine Subsidence Insurance Fund.

Cover photo Track-mounted duckbill loading machine at a Peabody Coal Company mine, ca. 1915.

DISCLAIMER: The accuracy and completeness of mine maps and directories vary with the availability of reliable information. Maps and other information used to compile this mine map and directory were obtained from a variety of sources and the accuracy of some of the original information cannot be verified. Consequently, the Illinois State Geological Survey (ISGS) cannot guarantee the mine maps are free of errors and disclaims any responsibility for damages that may result from actions or decisions based on them.

The ISGS updates the maps and directories periodically, and welcomes any new information or corrections. Please contact the Coal Section of the ISGS at the address shown on the title page of this directory, or telephone (217) 333-4747.

© 2023 The Board of Trustees of the University of Illinois. All rights reserved.
For permission information, contact the Illinois State Geological Survey.

CONTENTS

INTRODUCTION	1
MINING IN GREENFIELD QUADRANGLE	1
PART I EXPLANATION OF MAP AND MINE SUMMARY SHEET	2
INTERPRETING THE MAP	2
Mine Type and Mining Method	2
SOURCE MAPS	3
POINTS AND LABELS	3
INTERPRETING A MINE SUMMARY SHEET	6
REFERENCES	8
PART II DIRECTORY OF MINES IN THE GREENFIELD QUADRANGLE	9
MINE SUMMARY SHEETS	9
Mine Index 329	
A. N. Poli, Greenfield Mine	9
Mine Index 347	
Greenfield Coal Company, Greenfield Mine	10
Mine Index 749	
Kincaid & Mitchell, Kincaid & Mitchell Mine	11
Mine Index 2923	
John B. Falcutt, Falcutt Mine	12
Mine Index 2924	
John J. Harbaugh, Harbaugh No. 1 Mine	13
Mine Index 2925	
Stanley Palulis, Palulis No. 1 Mine	14
Mine Index 2926	
Bowman & Johnson, Bowman & Johnson Mine	15
Mine Index 2927	
Claude Pitchford, Pitchford Mine	16
Mine Index 2928	
Davis Brothers, Davis Mine	17
Mine Index 2929	
Frank Davis & Brothers, Davis Mine	18
Mine Index 2930	
Kirchner, Wyatt & Spicer; Kirchner, Wyatt & Spicer Mine	19
Mine Index 6428	
A. Collins, Collins Mine	20
Mine Index 6429	
J. M. Garbett, Community Mine	21
Mine Index 6430	
D. & G. Coal Company, Greenfield Mine	22
Mine Index 6432	
James O'Brien, O'Brien Mine	23
OTHER MINES SHOWN ON GREENFIELD QUADRANGLE	24
Mine index 4546	24
Mine Index 4547	24
Mine Index 4548, Spicer Mine	24
Mine Index 4551	24
Mine Index 6431	24
Mine Index 7864	24
Mine Index 7865, Rands & Metcalf Mine	24
Mine Index 7866	24
Mine Index 7867	24
Mine Index 7868	24
Mine Index 7869	24
Mine Index 7878	24

Mine Index 7884	24
MINES WHOSE LOCATIONS ARE NOT KNOWN, GREENFIELD QUADRANGLE.	24
INDEX OF MINES IN GREENFIELD QUADRANGLE.....	25

INTRODUCTION

Coal has been mined in 77 counties of Illinois. More than 7,400 coal mines have operated since commercial mining began in Illinois about 1810; fewer than 30 are currently active. To detail the extent and location of coal mining in Illinois, the Illinois State Geological Survey (ISGS) has compiled maps and directories of known coal mines. The ISGS offers maps at a scale of 1:100,000 and accompanying directories for each county in which coal mining is known to have occurred. Maps at a scale of 1:24,000 and accompanying directories such as this are available for selected quadrangles. Contact the ISGS for a list of these quadrangles.

These larger scale maps show the approximate positions of mines in relation to surface features such as roads and water bodies, and indicate the mining method used and the accuracy of the mine boundaries. The maps are useful for locating mine boundaries relative to specific properties and for assessing the potential for subsidence in an area. Mine boundaries compiled from final mine surveys are generally shown within 200 feet of their true position. As a result of poor cartographic quality and inaccuracies in the original mine surveys, boundaries of some older mines may be mislocated on the map by 500 feet or more. Original mine maps should be consulted in situations that require precise delineation of mine boundaries or internal workings of mined areas.

The directory serves as a key to the accompanying mine map and provides basic information on the coal mines. The directory is composed of two parts. Part I explains the symbols and patterns used on the accompanying map and the summary data presented for each mine. Part II numerically lists the mines in the quadrangle and summarizes the geology and production history of each mine.

MINING IN GREENFIELD QUADRANGLE

The Houchin Creek Coal was mined in the northern portion of the Greenfield Quadrangle, and the Herrin Coal was mined in the southeastern portion. Mining began before 1875, according to the 1875 Atlas of Macoupin County, and persisted through 1941. The mines were almost uniformly small (most less than 5 acres), with low annual production.

PART I EXPLANATION OF MAP AND MINE SUMMARY SHEET

INTERPRETING THE MAP

The map accompanying this directory shows the location of coal mines known to be present in the quadrangle. The map, corresponding to a U.S. Geological Survey (USGS) 7.5-minute quadrangle, covers an area bounded by lines of latitude and longitude 7.5-minutes apart. In Illinois, a quadrangle is approximately 6.5 miles east to west and 8.5 miles north to south, an area of about 56 square miles. The USGS generally offers one map of mines per quadrangle. In some areas where extensive mining occurred in two or more overlapping seams, separate maps are compiled for mines in each seam to maintain readability of the map.

Mine Type and Mining Method

The mine type is indicated on the map by pattern color: green represents surface mines; red and yellow represent underground mines. The red patterns are used for areas of underground mining that are documented by a primary or secondary source map. A yellow pattern is used for cases where no map of the mine workings is available, but a general area of mining can be inferred from property maps or production figures. The patterns indicate the main mining methods used in underground mines. The methods are (1) room and pillar and (2) high extraction. The method used gives some indication of the amount and pattern of coal extraction within each mined area, and has some influence on the timing and type of subsidence that can occur over a mine.

The following discussion and illustrations of mining methods are based on Guither et al. (1984).

In room-and-pillar mines, coal is removed from haulage-ways (entries) and selected areas called rooms. Pillars of unmined coal are left between the rooms to support the roof. Depending on the size of rooms and pillars, the amount of coal removed from the production areas will range from 40% to 70%.

Room and Pillar - mining is divided into six categories:

- room-and-pillar basic (RPB, fig. 1A), an early method that did not follow a preset mining plan and therefore resulted in very irregular designs;
- modified room and pillar (MRP, fig. 1B);
- room-and-pillar panel (RPP, fig. 1C);
- blind room and pillar (BRP, fig. 1D);
- checkerboard room and pillar (CRP, fig. 1E);
- room and pillar (RP), a classification used when the specific type of room-and-pillar mining is unknown.

Blind and checkerboard are the most common types of room-and-pillar mining used in Illinois today. The knowledge of room-and-pillar mining methods gives a trained engineer information on the nature of subsidence that may occur. A more extensive discussion of subsidence can be found in Bauer et al. (1993).

High-extraction These mining methods are subdivided into high-extraction retreat (HER, Fig 1F) and longwall (LW, Fig 1G, 1H). In these methods, much of the coal is removed within well defined areas of the mine. Subsidence of the surface above these areas occurs within weeks. Once the subsidence activity ceases, the potential for further movement over these areas is low; however, subsidence may continue for several years after mining.

High-extraction retreat mining is a form of room-and-pillar mining that extracts most of the coal. Rooms and pillars are developed in the panels, and the pillars are then systematically removed (fig. 1F).

In early (pre-1960) longwall mines, mining advanced in multiple directions from a central shaft (fig. 1G). Large pillars of coal were left around the shaft, but all coal was removed beyond these pillars. Miners placed rock and wooden props and cribs in the mined-out areas to support the mine roof. The overlying rock gradually settled onto these supports, thus producing subsidence at the surface. In post-1959 longwall mines, room-and-pillar methods have been used to develop the main entries of the mine and panel areas. Modern longwall methods extract 100 percent of the coal in the panel areas (fig. 1H).

SOURCE MAPS

Mine outlines depicted on the map are, whenever possible, based on maps made from original mine surveys. The process of compiling and digitizing the quadrangle map may produce errors of less than 200 feet in the location of mine boundaries. Larger errors of 500 feet or more are possible for mines that have incomplete or inaccurate source maps.

Because of the extreme complexity of some mine maps, detailed features of mined areas have been omitted. The digitized mine boundary includes the exterior boundary of all rooms or entries that were at least 80 feet wide or protruded 500 feet from the main mining area. Unmined areas between mines are shown if they are at least 80 feet wide; unmined blocks of coal within mines are shown if they are at least 400 feet on each side. Original source maps should be consulted when precise information on mine boundaries or interior features is needed.

The mine summary sheet lists the source maps used to determine each mine outline. The completeness of map sources is indicated on the map by a line symbol at the mine boundary. Source maps are organized in five categories.

Final mine map The mine outline was digitized from an original map made from mine surveys conducted within a few months after production ceased. The date of the map and the last reported production are listed on the summary sheet.

Not a final map The mine is currently active or the mine outline was made from a map based on mine surveys conducted more than a few months before production ceased. This implies the actual mined-out area is probably larger than the outline on the map. The mine summary sheet indicated the dates of source maps and the last reported production, as well as the approximate tonnage mined between these two dates (if the mine is abandoned). The summary sheet also lists the approximate acreage mined since the date of the map and, in some cases, indicates the area where additional mining may have taken place. This latter information is determined by locating on the map the active faces relative to probable boundaries of the mine property.

Undated map The source map was undated, so it may or may not be based on a final mine survey. When sufficient data are available, the probable acreage of the mined area is estimated from reported production, average seam thickness and a recovery rate comparable to other mines in the area. This information is listed in the summary sheet for the mine.

Incomplete map The source map did not show the entire mine. The summary sheet indicates the missing part of the mine map and the acreage of the unmapped area, which is estimated from the amount of coal known to have been produced from the mine.

Secondary source map The original mine map was not found so the outline shown was determined from secondary sources (e.g., outlines from small-scale regional maps published in other reports). The summary sheet describes the secondary sources.

POINTS AND LABELS

The locations of all known mine openings (shafts, slopes, and drifts) and surface mine tipples are plotted on the map. Tipples are areas where coal was cleaned, stockpiled, and loaded for shipping.

Only openings or tipples are plotted for mines without source maps. If the precise locations of these features are unknown, a special symbol is used to indicate the approximate location of the mine.

Each mine on the map is labeled with the names of the mine and operating company, ISGS mine index number, and years of operation (if known) if space permits. A seam designation is given on maps where more than one seam was mined. For a mine that operated under more than one name, only the most recent name is generally given. When a mine changed names or ownership shortly before closing, an earlier name is listed. All company and mine names are listed on the mine summary sheet in the directory, under the production history segment.



Figure 1 Mining methods: (A) room-and-pillar basic (RPB), (B) modified room and pillar (MRP), (C) room-and-pillar panel (RPP), (D) blind room and pillar (BRP).

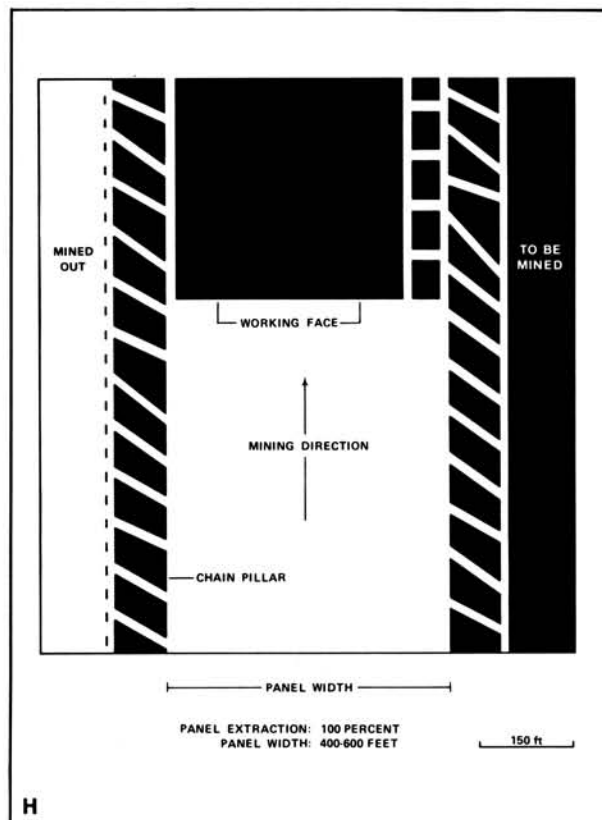
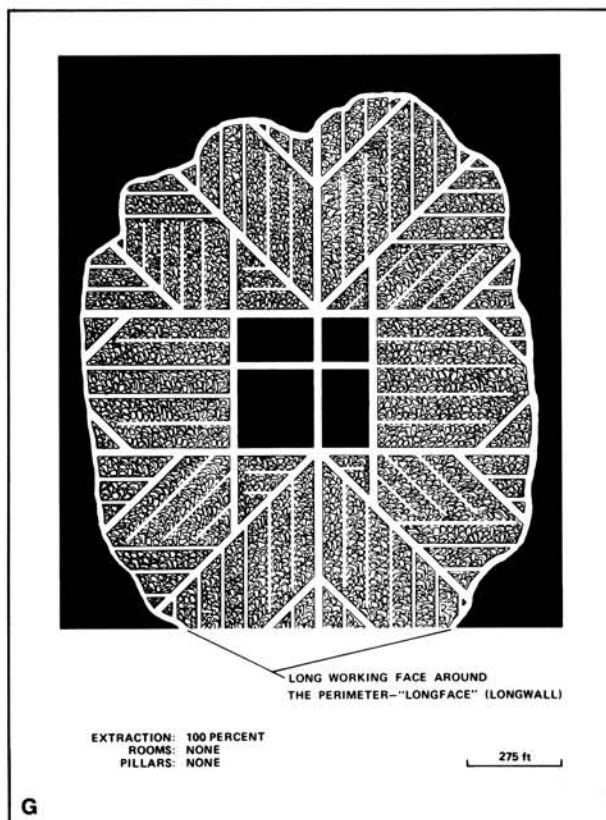
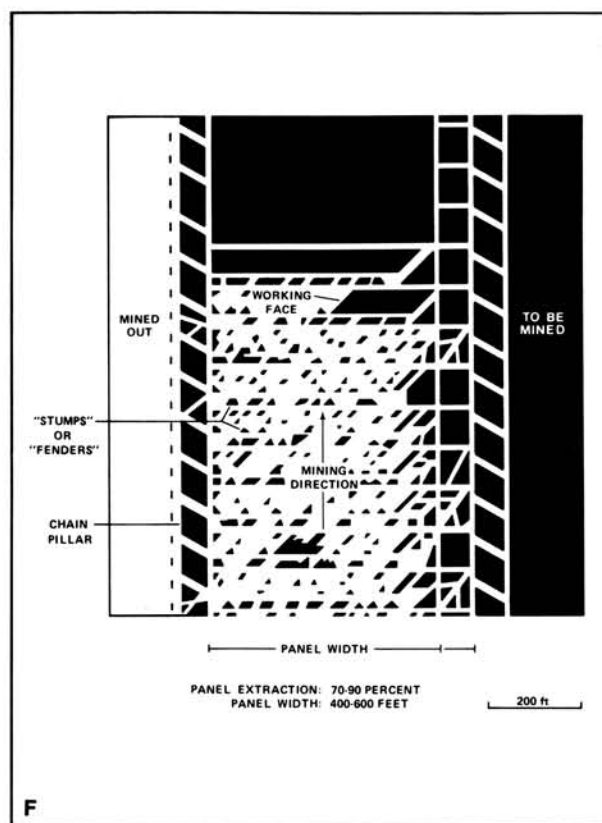
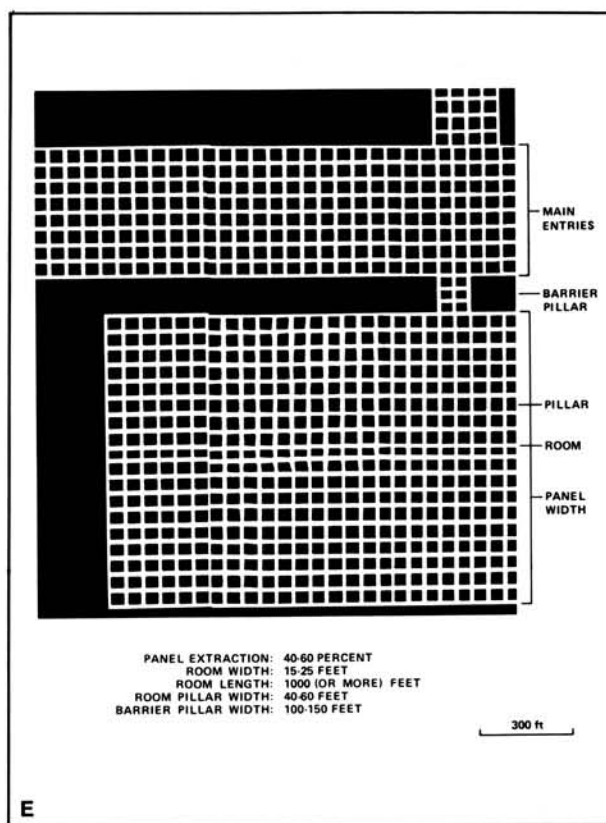

Figure 1 (cont.) Mining methods: (E) checkerboard room and pillar (CRP), (F) high extraction retreat (HER), (G) early (pre-1960) longwall, (H) post-1959 longwall



Figure 2 Generalized stratigraphic section, showing approximate vertical relations of coals in Illinois.

INTERPRETING A MINE SUMMARY SHEET

The mine summary sheet is arranged numerically by mine index number. Index numbers are shown on the map and in the mine listing. The mine summary sheet provides the following information (if available).

Company and mine name The last company or owner of the mine is used, unless no production was recorded for the last owner. In that case, the penultimate owner is listed. Mines often have no specific name; in these cases, the company name is also used as the mine name.

Type *Underground* denotes a subsurface mine in which the coal was reached through a shaft, slope, or a drift entry. *Surface* denotes a surface, open pit or strip mine.

Total mined-out acreage shown The total acreage of the mined area mapped, including any acreage mined on adjacent quadrangles, is calculated from the digitized outline of the mine. The acreage of large barrier pillars depicted on the map is excluded from the mined-out acreage. Small pillars not digitized are included in the acreage calculation. If the mine outline is not based on a final mine map, the acreage is followed by an estimate of additional acres that may have been mined. The estimate is determined from reported mine production, approximate thickness of the coal, and recovery rates calculated from nearby mines that used similar mining methods.

SHAFT, SLOPE, DRIFT OR TIPPLE LOCATIONS

Shaft, slope, drift, or tippie locations Locations of all known former entry points to underground mines or the location of coal cleaning, tippie, and shipping equipment used by the mine's facility are listed. The location is described in terms of county, township and range (Twp-Rge), section, and location within the section by quarters. NE SW NW, for instance, would describe the location in the northeast quarter of the southwest quarter of the northwest quarter. When sections are irregular in size, the quarters remain the same size and are oriented (or "registered") from the southeast corner of the section. Approximate footage from the section lines (FEL = from east line, FNL = from north line, for example) is given when that information is known; this indicates a surveyed location and is not derived from maps. Entry points are also plotted on the map and coded for the type of entry or tippie. A mine opening may have had many purposes during the life of the mine. Old hoist shafts are often later used for air and escape shafts; this information is included in the directory when known. The tippie for underground mines was generally located near the main shaft or slope. At surface mines, coal was sometimes hauled to a central tippie several miles from the mine pit.

GEOLOGY

Seam(s) mined The name of the coal seam(s) mined is listed, if known. If multiple seams were mined, they are all listed, although the mined-out area for each seam may be shown on separate maps. Figure 2 shows the stratigraphic section of the coal-bearing interval in Illinois, and the vertical relations among the coals.

Depth The depth to the top of the seam in the vicinity of the shaft is listed, if known. The depth is determined from notes made by geologists who visited the mine during its operation or from drill hole data in ISGS files. Depth generally varies little over the extent of a mine; however, reported depths for an individual mine may vary. Depth for surface-mined coals varies, and is usually represented as a range.

Thickness The approximate thickness of the mined seam is shown, if known. Thickness also comes from notes of geologists who visited the mine during its operation or from borehole data in ISGS files. Minimum, maximum, and average thicknesses are given when this information is available.

Mining method The principal mining method used at the mine (figs. 1A-H) is listed. See the mining methods section at the beginning of this directory for a discussion of this parameter.

Geologic problems reported Any known geologic problems, such as faults, water seepage, floor heaving, and unstable roof, encountered in the mine are reported. This information is from notes made by ISGS geologists who visited the mine, or from reports by mine inspectors published by the Illinois Department of Mines and Minerals, or from the source map(s). Geologic problems are not reported for active mines.

PRODUCTION HISTORY

Production history Tons of coal produced from the mine by each mine owner are totaled. When the source map used for the mine outline is not a final mine map, the tonnage produced since the date of the map is identified. For mines that extend into adjacent quadrangles, the tonnage reported includes areas mined in adjacent quadrangles.

SOURCE OF DATA

Source map This section lists information about the map(s) used to compile the mine outline and the locations of tipples and mine openings. In some cases more than one source map was used. For example, a map drawn before the mine closed may provide better information on original areas of the mine than a later map. When more than one map was used, the bibliography section explains what information was taken from each source.

Date The date of the most recent mine survey listed on the source map is reported.

Original scale The original scale of the source map is listed. Many maps are photo-reductions and are no longer at their original scale. The original scale gives some indication of the level of detail of the mine outline and the accuracy of the mine boundary relative to surface features. Generally, the larger the scale, the greater the accuracy and detail of the mine map. Mine outlines taken from source maps at scales smaller than 1:24,000 may be highly generalized and may well be inaccurately located with respect to surface features.

Digitized scale The scale of the digitized map is reported. The scale may be different from that of the original source map. In many cases the digitized map was made from a photo-reduction of the original source map, or the source map was not in a condition suitable for digitizing and the mine boundaries were transferred to another base map.

Map type Source maps are classified into five categories to indicate the probable completeness of the map. See discussion of source maps in the previous section.

Annotated bibliography Sources that provide information about the mine are listed, with the data taken from each source. Some commonly used sources are described below. Full bibliographic references are given for all other sources. Unless otherwise noted, all sources are available for public inspection at the ISGS.

Coal Reports Published since 1881, these reports contain tabular data on mine ownership, production, employment, and accidents. Some volumes include short descriptions made by mine inspectors of physical features and conditions in selected mines.

Directory of Illinois Coal Mines This source is a compilation of basic data about Illinois coal mines, originally gathered by ISGS staff in the early 1950s. Sources used for this directory are undocumented, but they are primarily Illinois Department of Mines and Minerals annual reports, ISGS mine notes, and coal company officials.

ENR Document 85/01, Guither, H. D., J. K. Hines, and R. A. Bauer, 1985 The Economic Effect of Underground Mining Upon Land Used for Illinois Agriculture: Illinois Department of Energy and Natural Resources Document 85/01, 185 p.

Microfilm map The U.S. Bureau of Mines maintains a microfilm archive of mine maps. A microfilm file for Illinois is available for public viewing at the ISGS.

Mine notes ISGS geologists have visited mines or contacted mine officials throughout the state since the early 1900s. Notes made during these visits range from brief descriptions of the mine location to long narratives (including sketches) of mining conditions and geology.

Federal Land Bank of St. Louis, Preliminary Reports on Subsidence Investigations Mining engineers working for the Federal Land Bank of St. Louis mapped areas of subsidence due to coal mining in the early 1930s. These reports often include county maps of mine properties with mined-out areas including shaft locations, as well as subsidence areas.

REFERENCES

Atlas of Macoupin County and the State of Illinois, 1875, Chicago: Warner and Beers, 89p.

Bauer, R. A., B. A. Trent, and P. B. Dumontelle, 1993, Mine Subsidence in Illinois: Facts for the Homeowner Considering Insurance: Illinois State Geological Survey, Environmental Geology Note 144, 16p.

Guither, H. D., J. K. Hines, and R. A. Bauer, 1985, The Economic Effects of Underground Mining Upon Land Used for Illinois Agriculture: Illinois Department of Energy and Natural Resources Document 85/01, 185 p.

History of Macoupin County, 1879, Philadelphia: Brink, McDonough & Co., 228 p.

PART II DIRECTORY OF MINES IN THE GREENFIELD QUADRANGLE

MINE SUMMARY SHEETS

A summary sheet on the geology and production history of each mine in the Greenfield Quadrangle is provided. These summary sheets are arranged numerically by mine index number. Consult Part I for a complete explanation of the data listed in the summary sheet.

Mine Index 329

A. N. Poli, Greenfield Mine

Type: Underground Total mined-out acreage shown: None; production indicates approximately 2 acres were mined.

SHAFT, SLOPE, DRIFT or TIPPLE LOCATIONS

Type	County	Township-Range	Section	Quarters-Footage
Main slope or shaft	Greene	11N 10W	27	SW NW SE

GEOLOGY

Seam(s) Mined	Depth (ft)	Thickness (ft)			Mining Method
		Min	Max	Avg	
Houchin Creek	55-95	4.0	8.0	6.0	RP

Geologic Problems Reported: The roof was soapstone (a massive light gray shale) and 18 inches of top coal was left to support the roof. Some water entered the mine through slips in the roof. The coal was banded with shale, pyrite, and black jack, charcoal or bone coal. The floor consisted of over 13 feet of clay.

PRODUCTION HISTORY

Company	Mine Name	Years	Production (tons)
Greenfield Mining Company	Greenfield	1919-1920	1,602
Mitchell & Son	Greenfield	1920-1922 *	787
A. N. Poli	Greenfield **	1922-1923	6,679
			9,068

* Production was not reported in 1922 for mines producing less than 10,000 tons.

** Also known as Old Poli Mine

Last reported production: 1923

SOURCES OF DATA

Source Map	Date	Original Scale	Digitized Scale	Map Type
Mine notes	Undated	1:62500	1:62500	Secondary source

Annotated Bibliography (data source, brief description of information)

Coal Reports - Production, ownership, years of operation, depth.

Directory of Illinois Coal Mines (Greene County) - Mine names, mine index, ownership, years of operation.

Mine notes (Greene County) - Mine type, shaft or slope location, depth, thickness, geologic problems.

Mine Index 347
Greenfield Coal Company, Greenfield Mine

Type: Underground Total mined-out acreage shown: None; production indicates approximately 8 acres were mined.

SHAFT, SLOPE, DRIFT or TIPPLE LOCATIONS

Type	County	Township-Range	Section	Quarters-Footage
Main shaft	Greene	11N 10W	27	SW NE SW *

* Note: The mine notes and field notes have numerous locations given for the New Poli Mine, sometimes even calling it the Old Poli Mine. We have followed the correction made by W. H. Smith and Dwain Berggren in 1959 as the most likely correct vicinity for the New Poli Mine (p. 5 & 6 of the collected field notes for mine index 347).

GEOLOGY

Seam(s) Mined	Depth (ft)	Thickness (ft)			Mining Method
		Min	Max	Avg	
Houchin Creek	100		9.0	7.0-8.0	Underground

Geologic Problems Reported: The lense of coal was about 0.5 miles wide and ran NE-SW. Top coal was left to protect and support the roof. The coal was banded with layers of clay or shale, pyrite, fusain, bone coal and charcoal.

PRODUCTION HISTORY

Company	Mine Name	Years	Production (tons)
A. N. Poli	Greenfield **	1927-1936 ***	31,168
Greenfield Coal Company	Greenfield	1937-1937	160
			31,328

** Also known as New Poli Mine

*** Idle 1929

Last reported production: 1937

SOURCES OF DATA

Source Map	Date	Original Scale	Digitized Scale	Map Type
Mine notes	Undated	1:62500	1:62500	Secondary source

Annotated Bibliography (data source, brief description of information)

Coal Reports - Production, ownership, years of operation.

Directory of Illinois Coal Mines (Greene County) - Mine names, mine index, ownership, years of operation.

Mine notes (Greene County) - Mine type, shaft location, seam, depth, thickness, geologic problems.

ISGS field notes (Greene County) - Thickness, geologic problems, shaft location.

Mine Index 749**Kincaid & Mitchell, Kincaid & Mitchell Mine**

Type: Underground Total mined-out acreage shown: None; production indicates approximately 9 acres were mined.

SHAFT, SLOPE, DRIFT or TIPPLE LOCATIONS

Type	County	Township-Range	Section	Quarters-Footage
Main shaft (11x5 ft)	Greene	11N 10W	27	NW SE SW

GEOLOGY

Seam(s) Mined	Depth (ft)	Thickness (ft)			Mining Method
		Min	Max	Avg	
Houchin Creek	52	4.83	7.0	5.5	RP

Geologic Problems Reported: The roof was black to gray shale that was soft and irregular in thickness, varying from 6 to 24 inches. The coal contained bands of mother coal, pyrite, and clay. The underclay was 2.5 feet thick.

PRODUCTION HISTORY

Company	Mine Name	Years	Production (tons)
E. E. Burroughs	Burroughs	1907-1909	13,600
Kincaid & Mitchell	Kincaid & Mitchell	1909-1916	<u>30,991</u>
			44,591

Last reported production: 1916

SOURCES OF DATA

Source Map	Date	Original Scale	Digitized Scale	Map Type
Mine notes	1909	1:62500	1:62500	Secondary source

Annotated Bibliography (data source, brief description of information)

Coal Reports - Production, ownership, years of operation.

Directory of Illinois Coal Mines (Greene County) - Mine names, mine index, ownership, years of operation.

Mine notes (Greene County) - Mine type, shaft location, depth, thickness, mining method, geologic problems.

Mine Index 2923

John B. Falcutt, Falcutt Mine

Type: Underground Total mined-out acreage shown: None; production indicates approximately 5 acres were mined.

SHAFT, SLOPE, DRIFT or TIPPLE LOCATIONS

Type	County	Township-Range	Section	Quarters-Footage
Main shaft	Macoupin	10N 9W	30	

GEOLOGY

Seam(s) Mined	Depth (ft)	Thickness (ft)			Mining Method
		Min	Max	Ave	
Herrin					UG

Geologic Problems Reported:

PRODUCTION HISTORY

Company	Mine Name	Years	Production (tons)
John B. Falcutt *	Falcutt	1923-1926 **	<u>23,432</u> 23,432

* variously spelled Falcutt, Falcetta, Falcith

** Idle 1925

Last reported production: 1926

SOURCES OF DATA

Source Map	Date	Original Scale	Digitized Scale	Map Type
Mine notes	Undated	(text only) ***	1:24000	Secondary source

*** Point plotted onto 1:24,000 USGS topographic map and digitized.

Annotated Bibliography (data source, brief description of information)

Coal Reports - Production, ownership, years of operation, depth, thickness.

Directory of Illinois Coal Mines (Macoupin County) - Mine names, mine index, ownership, years of operation.

Mine notes (Macoupin County) - Shaft location, mine type, seam.

Mine Index 2924**John J. Harbaugh, Harbaugh No. 1 Mine**

Type: Underground Total mined-out acreage shown: 9, as general area of mining Production indicates less than 2 acres were mined.

SHAFT, SLOPE, DRIFT or TIPPLE LOCATIONS

Type	County	Township-Range	Section	Quarters-Footage
Main shaft	Macoupin	10N 9W	30	SE SE SE

GEOLOGY

Seam(s) Mined	Depth (ft)	Thickness (ft)			Mining Method
		Min	Max	Ave	
Herrin	28-48			4.0-4.5	RP

Geologic Problems Reported:

PRODUCTION HISTORY

Company	Mine Name	Years	Production (tons)
John J. Harbaugh	Harbaugh No. 1	1907-1917 *	<u>5,640</u> 5,640

* Idle 1912-1916

Last reported production: 1917

SOURCES OF DATA

Source Map	Date	Original Scale	Digitized Scale	Map Type
Federal Land Bank Report	4-1934	1:126720	1:126720	Secondary source
Mine notes	1902	1:62500	1:62500	Secondary source

Annotated Bibliography (data source, brief description of information)

Coal Reports - Production, ownership, years of operation, depth, thickness.

Directory of Illinois Coal Mines (Macoupin County) - Mine names, mine index, ownership, years of operation.

Mine notes (Macoupin County) - Shaft location, seam.

Federal Land Bank Report (Macoupin County) - Mine location, general area of mining.

Mine Index 2925
Stanley Palulis, Palulis No. 1 Mine

Type: Underground Total mined-out acreage shown: None Production indicates 1 acre was mined.

SHAFT, SLOPE, DRIFT or TIPPLE LOCATIONS

Type	County	Township-Range	Section	Quarters-Footage
Main shaft	Macoupin	10N 9W	30	SW SE SE

GEOLOGY

Seam(s) Mined	Depth (ft)	Thickness (ft)			Mining Method
		Min	Max	Ave	
Herrin	50		7.0	5.0-5.5	RP

Geologic Problems Reported:

PRODUCTION HISTORY

Company	Mine Name	Years	Production (tons)
Thomas R. Rand	Rand	1897-1903 *	2,420
Challons Coal Company	Challons	1934-1935	866
Orval Greenstreet	Greenstreet	1935-1935	1,030
Stanley Palulis	Palulis No. 1	1935-1936	896
			5,212

* Idle 1900

Last reported production: 1936

SOURCES OF DATA

Source Map	Date	Original Scale	Digitized Scale	Map Type
Mine notes	6-7-1937	1:62500	1:62500	Secondary source

Annotated Bibliography (data source, brief description of information)

Coal Reports - Production, ownership, years of operation, depth, thickness, mining method.

Directory of Illinois Coal Mines (Macoupin County) - Mine names, mine index, ownership, years of operation.

Mine notes (Macoupin County) - Mine type, shaft location, seam, depth, thickness.

Mine Index 2926**Bowman & Johnson, Bowman & Johnson Mine**

Type: Underground Total mined-out acreage shown: 19, as general area of mining Production indicates less than 1 acre was mined.

SHAFT, SLOPE, DRIFT or TIPPLE LOCATIONS

Type	County	Township-Range	Section	Quarters-Footage
Main shaft	Macoupin	10N 9W	30	SW SW SE

GEOLOGY

Seam(s) Mined	Depth (ft)	Thickness (ft)			Mining Method
		Min	Max	Ave	
Herrin					UG

Geologic Problems Reported:

PRODUCTION HISTORY

Company	Mine Name	Years	Production (tons)
Bowman & Johnson	Bowman & Johnson	1936-1936	<u>100</u> 100

Last reported production: 1936

SOURCES OF DATA

Source Map	Date	Original Scale	Digitized Scale	Map Type
Mine notes	Undated	1:62500	1:62500	Secondary source
Federal Land Bank Report	4-1934	1:126720	1:126720	Secondary source

Annotated Bibliography (data source, brief description of information)

Coal Reports - Production, ownership, years of operation.

Directory of Illinois Coal Mines (Macoupin County) - Mine names, mine index, ownership, years of operation.

Mine notes (Macoupin County) - Shaft location, seam.

Federal Land Bank Report (Macoupin County) - Mine location, general area of mining.

Mine Index 2927
Claude Pitchford, Pitchford Mine

Type: Underground Total mined-out acreage shown: 11, as general area of mining Production indicates less than 2 acres were mined.

SHAFT, SLOPE, DRIFT or TIPPLE LOCATIONS

Type	County	Township-Range	Section	Quarters-Footage
Main slope	Macoupin	10N 9W	30	SE NE SE

GEOLOGY

Seam(s) Mined	Depth (ft)	Thickness (ft)			Mining Method
		Min	Max	Ave	
Herrin	15-75			5.0-7.5	RP

Geologic Problems Reported:

PRODUCTION HISTORY

Company	Mine Name	Years	Production (tons)
Claude E. Pitchford	Pitchford	1914-1920	8,043
Claude Pitchford	Pitchford	1929-1934 *	679
Claude Pitchford	Pitchford	1939-1941	430
			9,152

* Tonnage not reported for mines producing less than 1000 tons per year from 1930 to 1933.

Last reported production: 1941

SOURCES OF DATA

Source Map	Date	Original Scale	Digitized Scale	Map Type
Mine notes	Undated	(text only)	1:24000 **	Secondary source
Federal Land Bank Report	4-1934	1:126720	1:126720	Secondary source

** Point plotted onto 1:24,000 USGS topographic map and digitized.

Annotated Bibliography (data source, brief description of information)

Coal Reports - Production, ownership, years of operation, seam, depth, thickness, mining method.
 Directory of Illinois Coal Mines (Macoupin County) - Mine names, mine index, ownership, years of operation.
 Mine notes (Macoupin County) - Mine type, slope location, depth, thickness.
 Federal Land Bank Report (Macoupin County) - Mine location, general area of mining.

Mine Index 2928
Davis Brothers, Davis Mine

Type: Underground Total mined-out acreage shown: 19, as general area of mining Production indicates 4 acres were mined.

SHAFT, SLOPE, DRIFT or TIPPLE LOCATIONS

Type	County	Township-Range	Section	Quarters-Footage
Main shaft	Macoupin	10N 9W	30	SE NW SE

GEOLOGY

Seam(s) Mined	Depth (ft)	Thickness (ft)			Mining Method
		Min	Max	Ave	
Herrin	20-47			4.0-7.0	RP

Geologic Problems Reported:

PRODUCTION HISTORY

Company	Mine Name	Years	Production (tons)
Dorris Davis	Davis	1882-1885 *	6,000
Davis Brothers	Davis	1885-1890	<u>12,654</u>
			18,654

* Idle 1885

Last reported production: 1890

SOURCES OF DATA

Source Map	Date	Original Scale	Digitized Scale	Map Type
Mine notes	Undated	1:62500	1:62500	Secondary source
Federal Land Bank Report	4-1934	1:126720	1:126720	Secondary source

Annotated Bibliography (data source, brief description of information)

Coal Reports - Production, ownership, years of operation, seam, depth, thickness, mining method.
 Directory of Illinois Coal Mines (Macoupin County) - Mine names, mine index, ownership, years of operation.
 Mine notes (Macoupin County) - Shaft location, seam, depth, thickness.
 Federal Land Bank Report (Macoupin County) - Mine location, general area of mining.

Mine Index 2929
Frank Davis & Brothers, Davis Mine

Type: Underground Total mined-out acreage shown: 17, as general area of mining Production indicates 2 acres were mined.

SHAFT, SLOPE, DRIFT or TIPPLE LOCATIONS

Type	County	Township-Range	Section	Quarters-Footage
Main shaft	Macoupin	10N 9W	30	NE NE SE
Air shaft	Macoupin	10N 9W	30	SW SE NE

GEOLOGY

Seam(s) Mined	Depth (ft)	Thickness (ft)			Mining Method
		Min	Max	Ave	
Herrin	75 (10-90)			7.0	RP

Geologic Problems Reported:

PRODUCTION HISTORY

Company	Mine Name	Years	Production (tons)
R. R. Davis	Davis	1898-1899	100
Davis Brothers	Davis	1899-1906 *	10,898
Frank Davis & Brothers	Davis	1906-1907	400
			11,398

* Idle 1902

Last reported production: 1907

SOURCES OF DATA

Source Map	Date	Original Scale	Digitized Scale	Map Type
Mine notes	Undated	1:62500	1:62500	Secondary source
Federal Land Bank Report	4-1934	1:126720	1:126720	Secondary source
ISGS field notes (H. E. Culver)	11-9-1922	1:62500	1:62500	Secondary source
ISGS field notes (D. M. Collingwood)	1923	1:62500	1:62500	Secondary source

Annotated Bibliography (data source, brief description of information)

Coal Reports - Production, ownership, years of operation, depth, mining method.
 Directory of Illinois Coal Mines (Macoupin County) - Mine names, mine index, ownership, years of operation.
 Mine notes (Macoupin County) - Shaft location, seam, depth, thickness.
 Federal Land Bank Report (Macoupin County) - Mine location, general area of mining.
 ISGS field notes (Macoupin County) - Shaft locations.

Mine Index 2930**Kirchner, Wyatt & Spicer; Kirchner, Wyatt & Spicer Mine**

Type: Underground Total mined-out acreage shown: 20, as general area of mining Production indicates about 3 acres were mined.

SHAFT, SLOPE, DRIFT or TIPPLE LOCATIONS

Type	County	Township-Range	Section	Quarters-Footage
Main shaft	Macoupin	10N 9W	31	NW NW NW

GEOLOGY

Seam(s) Mined	Depth (ft)	Thickness (ft)			Mining Method
		Min	Max	Ave	
Herrin	23-54			6.0-7.0	RP

Geologic Problems Reported:

PRODUCTION HISTORY

Company	Mine Name	Years	Production (tons)
Cogger & Company	Cogger	1886-1890	9,563
Charles Trill	Trill	1890-1893	6,558
Trill Brothers	Trill	1896-1896	150
W. H. Walden & Son	Walden	1935-1935 *	120
Kirchner, Wyatt & Spicer	Kirchner, Wyatt & Spicer	1936-1936	<u>162</u>
			16,553

* Idle or abandoned 1896-1935

Last reported production: 1936

SOURCES OF DATA

Source Map	Date	Original Scale	Digitized Scale	Map Type
Mine notes	Undated	1:62500	1:62500	Secondary source
Federal Land Bank Report	4-1934	1:126720	1:126720	Secondary source

Annotated Bibliography (data source, brief description of information)

Coal Reports - Production, ownership, years of operation, depth, thickness, mining method.

Directory of Illinois Coal Mines (Macoupin County) - Mine names, mine index, ownership, years of operation.

Mine notes (Macoupin County) - Ownership, shaft location, seam.

Federal Land Bank Report (Macoupin County) - Mine location, general area of mining.

Mine Index 6428**A. Collins, Collins Mine**

Type: Underground Total mined-out acreage shown: None; production indicates approximately 4 acres were mined.

SHAFT, SLOPE, DRIFT or TIPPLE LOCATIONS

Type	County	Township-Range	Section	Quarters-Footage
Main shaft	Greene	11N 10W	27	SW SE SW

GEOLOGY

Seam(s) Mined	Depth (ft)	Thickness (ft)			Mining Method
		Min	Max	Avg	
Houchin Creek	57			2.5-6.0	RP

Geologic Problems Reported:

PRODUCTION HISTORY

Company	Mine Name	Years	Production (tons)
Solomon & Sturman	Solomon & Sturman	1902-1903	200
A. Collins	Collins	1903-1907	<u>10,180</u> 10,380

Last reported production: 1907

SOURCES OF DATA

Source Map	Date	Original Scale	Digitized Scale	Map Type
Mine notes	Undated	1:62500	1:62500	Secondary source
Coal Section files (Greenfield Quadrangle)	Undated	1:62500	1:62500	Secondary source

Annotated Bibliography (data source, brief description of information)

Coal Reports - Production, ownership, years of operation, thickness, mining method.

Directory of Illinois Coal Mines (Greene County) - Mine names, mine index, ownership, years of operation.

Mine notes (Greene County) - Mine type, shaft location, depth, thickness.

Coal Section files, undated work map on USGS topographic map, Greenfield (15') Quadrangle - Shaft location.

Mine Index 6429**J. M. Garbett, Community Mine**

Type: Underground Total mined-out acreage shown: 3; production indicates less than 1 acre was mined after the map date.

SHAFT, SLOPE, DRIFT or TIPPLE LOCATIONS

Type	County	Township-Range	Section	Quarters-Footage
Main shaft	Greene	11N 10W	27	SW NE SW
Air shaft	Greene	11N 10W	27	SE NE SW

GEOLOGY

Seam(s) Mined	Depth (ft)	Thickness (ft)			Mining Method
		Min	Max	Avg	
Houchin Creek	100			3.5	RPB

Geologic Problems Reported:

PRODUCTION HISTORY

Company	Mine Name	Years	Production (tons)
Greene County Coal Company	Community	1935-1935	435
J. M. Gobel	Community	1936-1936	2,836
Community Coal Company	Community	1937-1938	1,780
J. M. Garbett	Community	1938-1938	507 *
			5,558

* Production after map date

Last reported production: 1938

SOURCES OF DATA

Source Map	Date	Original Scale	Digitized Scale	Map Type
Microfilm, document 351567	1-16-1938	1:1200	1:1655	Not final

Annotated Bibliography (data source, brief description of information)

Coal Reports - Production, ownership, years of operation.

Directory of Illinois Coal Mines (Greene County) - Mine names, mine index, ownership, years of operation.

Mine notes (Greene County) - Mine type, shaft location, depth, thickness.

Microfilm map, document 351567, reel 03136, frame 342 - Shaft locations, mine outline, mining method.

Mine Index 6430**D. & G. Coal Company, Greenfield Mine**

Type: Underground Total mined-out acreage shown: None; production indicates approximately 1 acre was mined.

SHAFT, SLOPE, DRIFT or TIPPLE LOCATIONS

Type	County	Township-Range	Section	Quarters-Footage
Main shaft	Greene	11N 10W	27	NW SW SE

GEOLOGY

Seam(s) Mined	Depth (ft)	Thickness (ft)			Mining Method
		Min	Max	Avg	
Houchin Creek	95			6.5-7.17	RP

Geologic Problems Reported:

PRODUCTION HISTORY

Company	Mine Name	Years	Production (tons)
Greenfield Mining Company *	Greenfield	1916-1917	953
D. & G. Coal Company	Greenfield	1917-1918	<u>3,560</u>
			4,513

* Operated by F. Young

Last reported production: 1918

SOURCES OF DATA

Source Map	Date	Original Scale	Digitized Scale	Map Type
Mine notes	Undated	1:62500	1:62500	Secondary source

Annotated Bibliography (data source, brief description of information)

Coal Reports - Production, ownership, years of operation, depth, thickness, mining method.

Directory of Illinois Coal Mines (Greene County) - Mine names, mine index, ownership, years of operation.

Mine notes (Greene County) - Mine type, shaft location, seam, depth, thickness.

Mine Index 6432
James O'Brien, O'Brien Mine

Type: Underground Total mined-out acreage shown: None; production indicates approximately 5 acres were mined.

SHAFT, SLOPE, DRIFT or TIPPLE LOCATIONS

Type	County	Township-Range	Section	Quarters-Footage
Main shaft	Greene	11N 10W	27	SW NE SW

GEOLOGY

Seam(s) Mined	Depth (ft)	Thickness (ft)			Mining Method
		Min	Max	Avg	
Houchin Creek	75				Underground

Geologic Problems Reported:

PRODUCTION HISTORY

Company	Mine Name	Years	Production (tons)
Dubincek & O'Brien	Dubincek & O'Brien	1925-1925	994
O'Brien & Moore	O'Brien & Moore	1926-1926	4,100
Greenfield Coal Company	Greenfield	1927-1927	4,221
James O'Brien	O'Brien	1928-1928	<u>2,652</u>
			11,967

Last reported production: 1928

SOURCES OF DATA

Source Map	Date	Original Scale	Digitized Scale	Map Type
Mine notes	1941	1:62500	1:62500	Secondary source
Coal Section files (Greenfield Quadrangle)	Undated	1:62500	1:62500	Secondary source

Annotated Bibliography (data source, brief description of information)

Coal Reports - Production, ownership, years of operation.
 Directory of Illinois Coal Mines (Greene County) - Mine names, mine index, ownership, years of operation.
 Mine notes (Greene County) - Mine type, shaft location, depth.
 Coal Section files, undated work map on USGS topographic map, Greenfield (15') Quadrangle - Shaft location.

OTHER MINES SHOWN ON GREENFIELD QUADRANGLE

Mine index 4546 SW SE SW 30-T10N-R9W, shaft source: Federal Land Bank Report (4-1934)
 Mine Index 4547 NW SE SE 30-T10N-R9W, shaft source: Federal Land Bank Report (4-1934)
 Mine Index 4548, Spicer Mine 30-T10N-R9W source: Mine notes (6-7-1937)
 Mine Index 4551 SW SW NE 30-T10N-R9W, shaft, source: Federal Land Bank Report (4-1934)
 Mine Index 6431 NW SW SE 27-T11N-R10W source: Coal Section files, Greenfield (15') Quadrangle work map
 Mine Index 7864 SW SW NW 29-T10N-R9W, slope source: ISGS field notes (D.M. Collingwood, 7-26-1923)
 Mine Index 7865, Rands & Metcalf Mine NE SE SE 30-T10N-R9W source: Mine notes (6-7-1937)
 Mine Index 7866 NE NW NW 31-T10N-R9W, shaft source: ISGS field notes (D.M. Collingwood, 1923)
 Mine Index 7867 NE SE SW 30-T10N-R9W, coal bank source: Atlas of Macoupin County (1875)
 Mine Index 7868 NW SW SE 30-T10N-R9W, coal bank source: Atlas of Macoupin County (1875)
 Mine Index 7869 SE SW SE 30-T10N-R9W, coal bank source: Atlas of Macoupin County (1875)
 Mine Index 7878 SW SW NW 29-T10N-R9W, shaft source: ISGS field notes (D.M. Collingwood, 7-26-1923)
 Mine Index 7884 SW NW SE 27-T10N-R10W, shaft source: ISGS field notes (G. H. Cady, 9-7-1927)

MINES WHOSE LOCATIONS ARE NOT KNOWN, GREENFIELD QUADRANGLE

The locations of the following mines are unknown, but the production tonnage, operating names, and nearest town were reported in the Annual Coal Reports. The operators listed below mined in or near the Greenfield Quadrangle. The information shown is similar to that presented on the summary sheets in the previous pages of this directory. The first item is the name the mine operated under as listed in the Coal Report, then the years the mine reported. If no physical data are available, the next item listed is the total tons produced by the mine. If physical data are available, the order of presentation is as follows: type of opening for the mine (drift, slope or shaft), depth of coal in feet, and thickness of coal in feet.

The total tons mined by these unlocated mines is 1,965 (1,822 underground and 143 mined by uncertain method), which would represent less than 1 acre, depending on the recovery factor, mining method, and numerous other factors. (Note: 1 square mile = 640 acres)

GREENFIELD (Greene County)

MINE INDEX

Elliott's Mine, 1882-1883, drift, Colchester, —, 2.5	unknown	90610005
Drake Brothers, 1883-1883	1,000 tons	
Parks (George), 1902-1903, slope or drift, —, 25-30, —, RP	192 tons	90610060
Hart (J.), 1903-1904	48 tons	
	240 tons	

GREENFIELD (Macoupin County)

Witt Coal Company, 1927-1927	143 tons	91170025
------------------------------	----------	----------

ROCKBRIDGE (Greene County)

Trill Brothers, 1893-1895, shaft, Springfield, 54, 7.0, RP	520 tons	90610037
--	----------	----------

SCOTTSVILLE (Greene County)

Duggan & Tully, 1903-1904, slope, —, 30, —, RP	62 tons	90610061
--	---------	----------

INDEX OF MINES IN GREENFIELD QUADRANGE

Bowman & Johnson	15
Burroughs (E. E.)	11
Challons Coal Company	14
Cogger & Company	19
Collins (A.)	20
Community Coal Company	21
D. & G. Coal Company	22
Davis (Dorris)	17
Davis (Frank)	18
Davis (R. R.)	18
Davis Brothers	17, 18
Drake Brothers	24
Dubincek & O'Brien	23
Duggan & Tully	24
Elliott's Mine	24
Falcetta	12
Falcith	12
Falcutt (John B.)	12
Garbett (J. M.)	21
Gobel (J. M.)	21
Greene County Coal Company	21
Greenfield Coal Company	10, 23
Greenfield Mining Company	9, 22
Greenstreet (Orval)	14
Harbaugh (John J.)	13
Hart (J.)	24
Johnson (Bowman & Johnson)	15
Kincaid & Mitchell	11
Kirchner, Wyatt & Spicer	19
Metcalf (Rands & Metcalf Mine)	24
Mitchell (Kincaid & Mitchell)	11
Mitchell & Son	9
Moore (O'Brien & Moore)	23
New Poli Mine	10
Old Poli Mine	9
O'Brien (Dubincek & O'Brien)	23
O'Brien (James)	23
O'Brien & Moore	23
Palulis (Stanley)	14
Parks (George)	24
Pitchford (Claude)	16
Poli (A. N.)	9, 10
Rand (Thomas R.)	14
Rands & Metcalf Mine	24
Solomon & Sturman	20
Spicer (Kirchner, Wyatt & Spicer)	19
Spicer Mine	24
Sturman (Solomon & Sturman)	20
Trill (Charles)	19
Trill Brothers	19, 24
Tully (Duggan & Tully)	24
Walden (W. H.)	19
Witt Coal Company	24
Wyatt (Kirchner, Wyatt & Spicer)	19
Young (F.)	22